

# **iAudioCloud**



## **User Instruction Manual**

**V1.4**  
**15, Jan. 2026**

# Content

<b>1. iAudioCloud Network Configuration .....</b>	<b>5</b>
1.1 Download iAudioCloud .....	5
1.2 First Time Connect Network.....	5
1.3 Add unconnected Devices to the Router .....	6
1.4 How to Re-Name the Device .....	7
<b>2. How to use iAudioCloud .....</b>	<b>7</b>
<b>2.1 Song Playback and Mode Switch .....</b>	<b>7</b>
2.2 Multi-room Playback.....	9
2.3 Favorite .....	10
2.4 My Music.....	11
2.5 Music Services .....	12
2.5.1 Tidal Usage .....	12
2.5.2 Qobuz Usage .....	13
2.5.3 Tunein Usage .....	13
2.5.4 VTuner Usage .....	14
2.5.5 USB Disk Usage .....	14
<b>3. Third-party player song push .....</b>	<b>15</b>
3.1 DLNA.....	15
3.2 Spotify Connect.....	15
3.3 Qobuz Connect.....	16

3.4 Airplay .....	16
<b>4. EQ .....</b>	<b>17</b>
4.1 Bass and Treble instructions .....	17
4.2 Preset EQ Settings .....	17
4.3 Parameter EQ instructions .....	19
<b>5. Home Music Sharing .....</b>	<b>20</b>
5.1 Play music from shared files .....	20
5.2 Play music from media server .....	21
<b>6. Subwoofer .....</b>	<b>22</b>
6.1 Device Pair and Automatic Reconnection .....	22
6.2 Functional Features and Usage Restrictions .....	23
<b>7. Left and Right Audio Channels .....</b>	<b>24</b>
<b>8. Network Status .....</b>	<b>25</b>
<b>9. Advanced Features .....</b>	<b>25</b>
9.1 Timed Control .....	25
9.1.1 Set-time Playback .....	25
9.1.2 Set-time Sleep .....	27
9.1.3 Timed Standby Mode .....	27
9.2 Preset Playback .....	28
9.2.1 Creating and Overwriting Presets .....	28
9.2.2 Managing the preset list .....	28
9.2.3 Edit Preset Parameters .....	29

9.3 Firmware Update .....	30
9.3.1 Manual Update .....	30
9.3.2 Silent Update .....	31
9.4 Question feedback function .....	32
9.4.1 Feedback operation steps .....	32
9.4.2 Feedback information suggestions .....	33
<b>10. FAQs and Support .....</b>	<b>33</b>

# 1. iAudioCloud Network Configuration

## 1.1 Download iAudioCloud

Pls download App: iAudioCloud from the App Store or Google Play (see Figure 1).



( Figure 1 )

## 1.2 First Time Connect Network

Open iAudioCloud, follow the app prompts , click "Add Device". After searching for the device that needs to be connected to the network and selecting it, enter the WiFi password of the matching router to connect the device to the network (see Figure 2).

Tips: Before using this APP, please make sure that the wireless streaming devices and your speakers are properly connected and in working condition.

Note: If the device cannot be found in the network, press the device network key(Re-set Key) to re-enter the network stage.

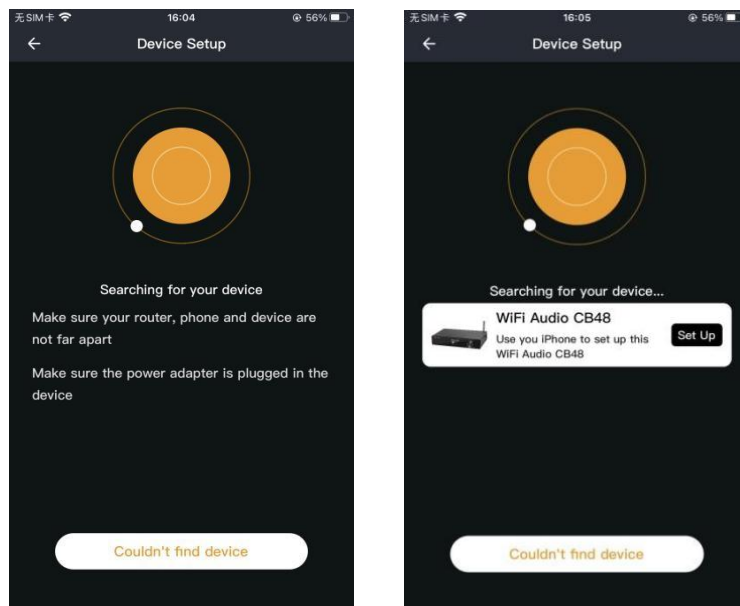

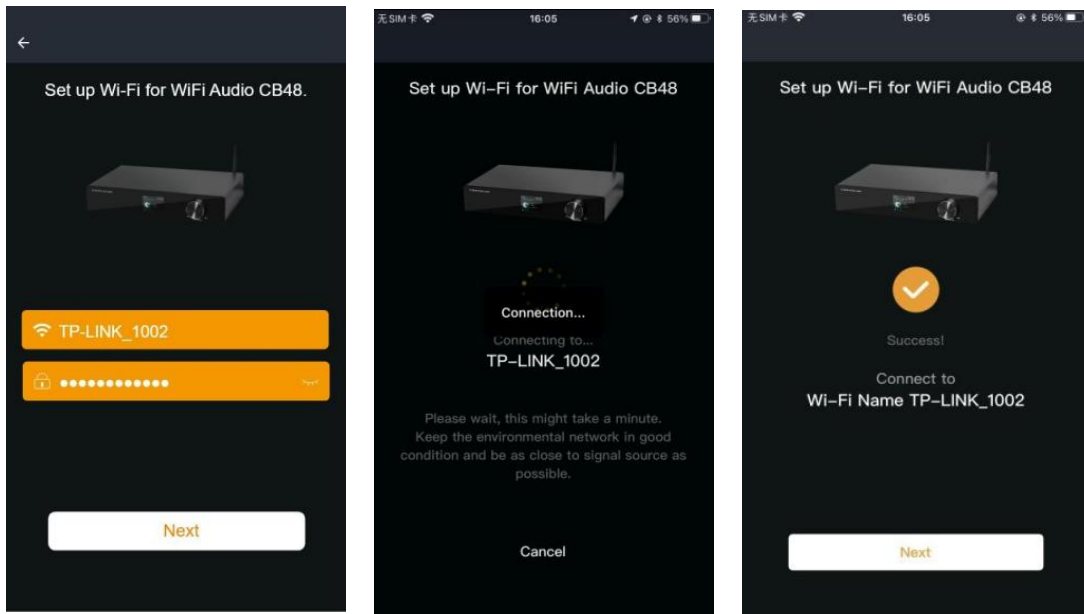

( Figure 2 )

### 1.3 Add unconnected Devices to the Router

To add other devices that are not yet connected to the home Wi-Fi network, follow these steps: Click the "+" icon in the device list and add the device using the same steps as the first device. After adding, you will see the new device in the device list (see Figure 3).

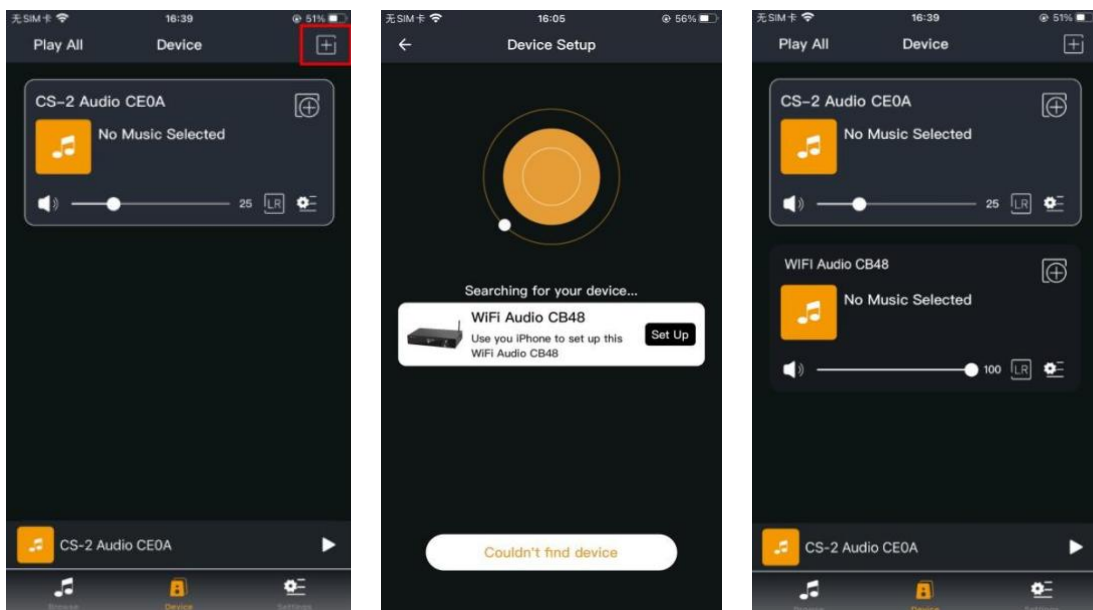

( Figure 3 )

## 1.4 How to Re-Name the Device

After adding a device, you can Re-name it if needed. For example, if you place a speaker in the bedroom, you can re-name it Bedroom, and another in the living room, you can re-name it Living Room (see Figure 4).

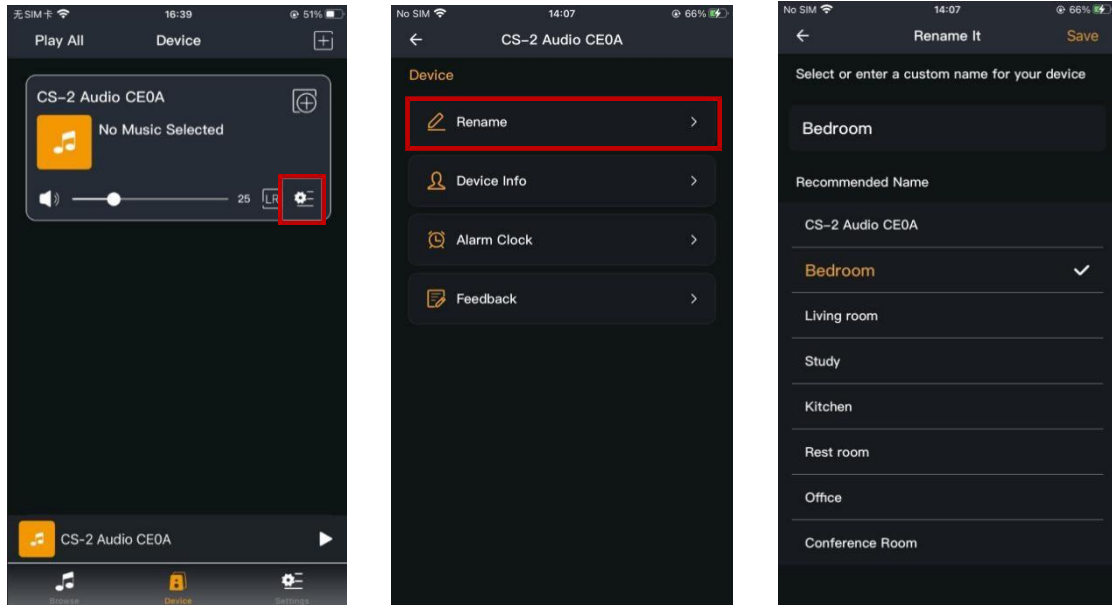

( Figure 4 )

## 2. How to use iAudioCloud

### 2.1 Song Playback and Mode Switch

This App offers features like local song push, volume control, and device source switch. In the APP Browse interface, you can click 'My Music' or music sources to select and play songs. Scroll down and change the device source directly within the app (see Figure 5).

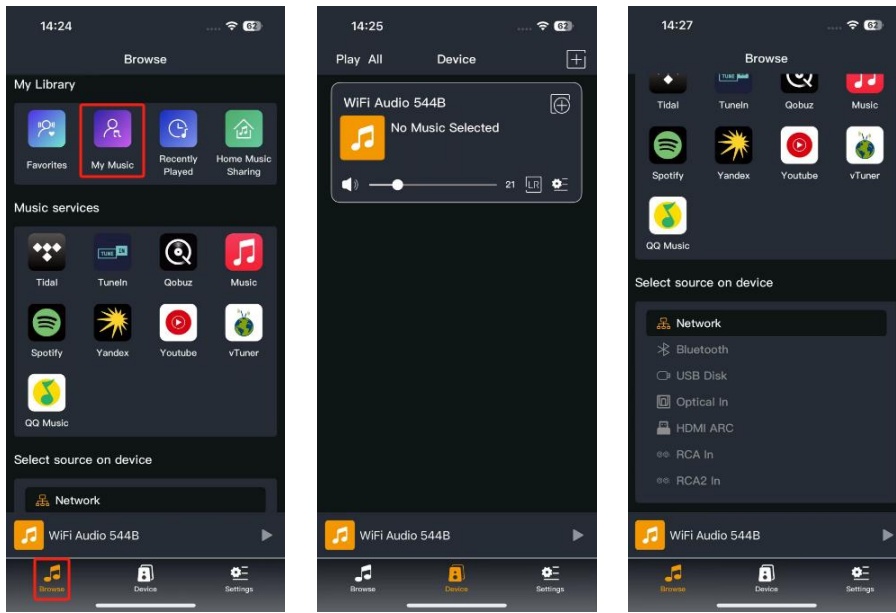

( Figure 5)

Click the play device on the app to access the playback interface, where you can easily view album images, progress, volume level, and loop settings (see Figure 6).

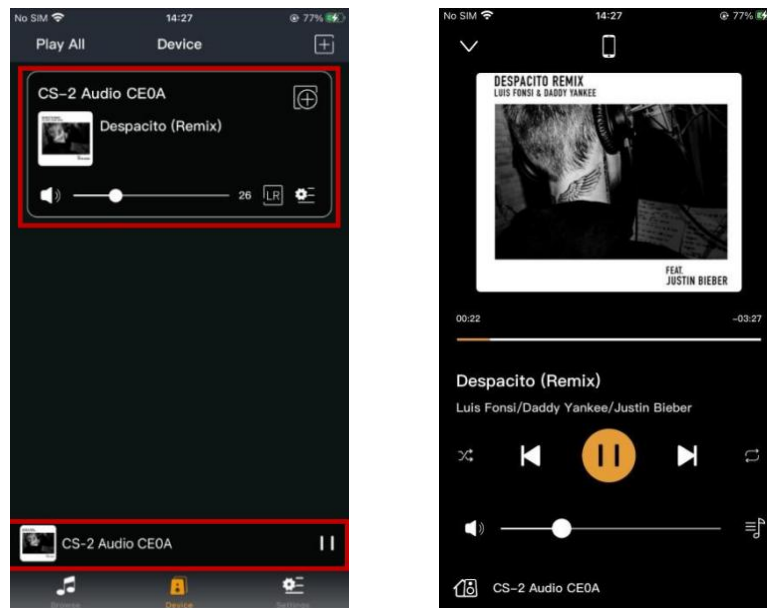

( Figure 6)

In the song playback details interface, you can open the playlist or delete it (see Figure 7).

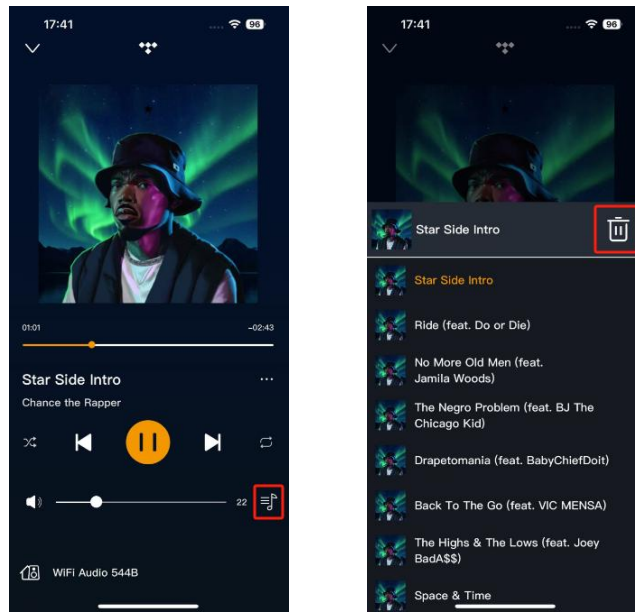

( Figure 7)

## 2.2 Multi-room Playback

This App also supports synchronized playback across devices. In the device list interface, click the '+' for the master speaker device, select other devices as slave speakers, and submit to enable real-time audio synchronization within the group, creating a more comfortable listening experience to you (see Figure 8).

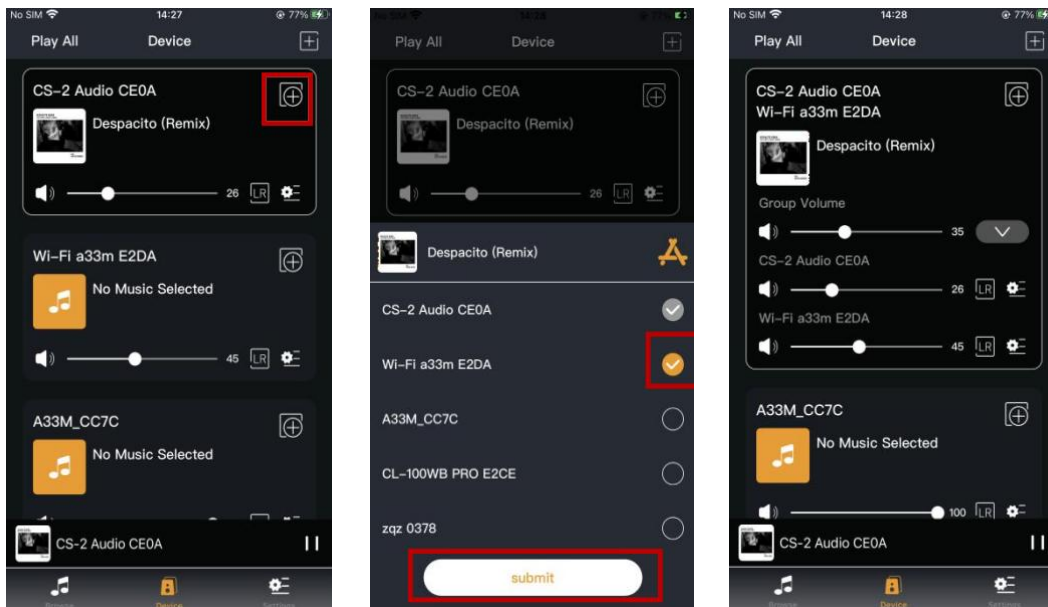

( Figure 8)

## 2.3 Favorite

The Favorite feature lets you freely save your favorite songs, In the 'Browse' interface, click the '...' icon next to a track in the 'My Music' playlist, or click the song directly in the playback interface to add it to your favorites. To manage your saved songs, simply click the Favorite interface from the 'Browse' screen (see Figure 9).

Note: The 'Favorite' feature is only available for collecting and managing local songs in 'My Music'. For songs from streaming services such as Tidal and Qobuz, please manage them using their own collection function within their respective music service apps or interfaces.

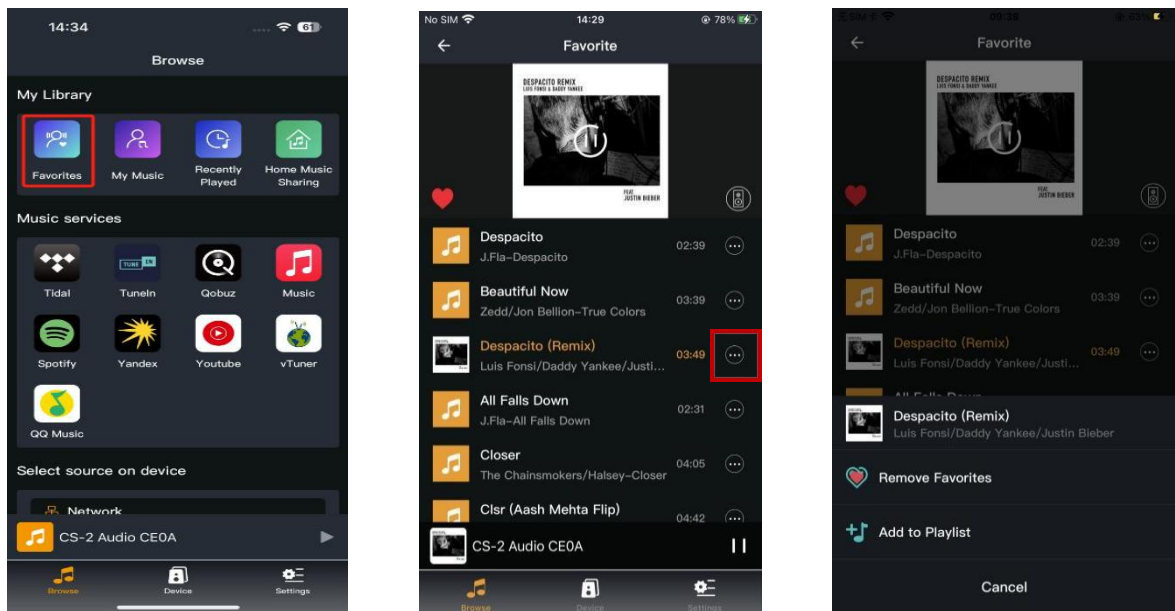

( Figure 9)

## 2.4 My Music

In the APP Browse interface, open My Music to view your phone's local songs and playlists. From the local song list, you can select tracks to play directly on the device, add them to playlists, or bookmark them in My Favorites (see Figure 10). You can also manage playlists here (see Figure 11).

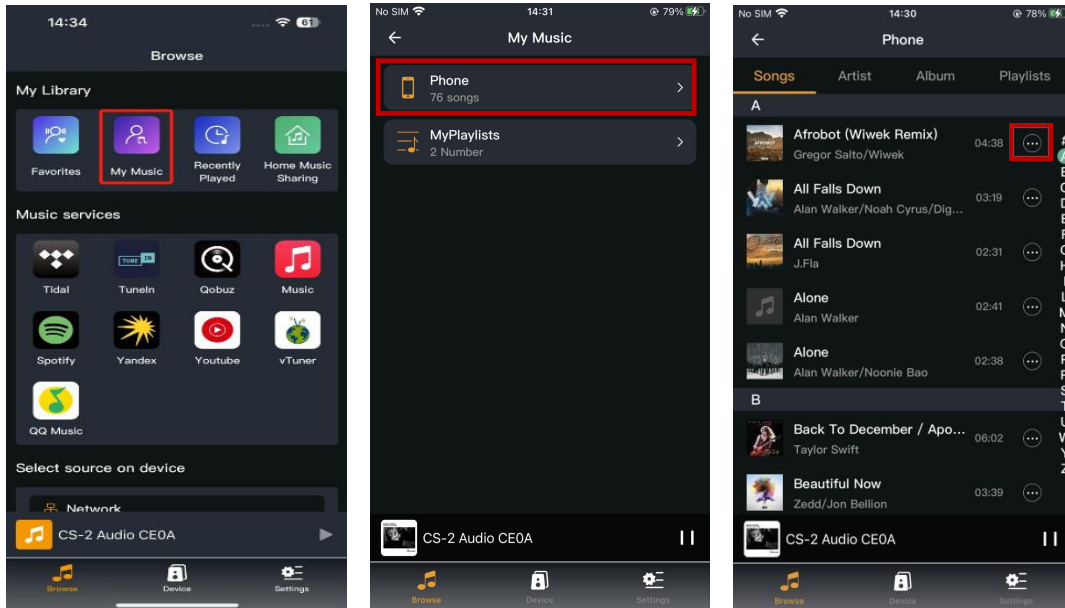

( Figure 10)

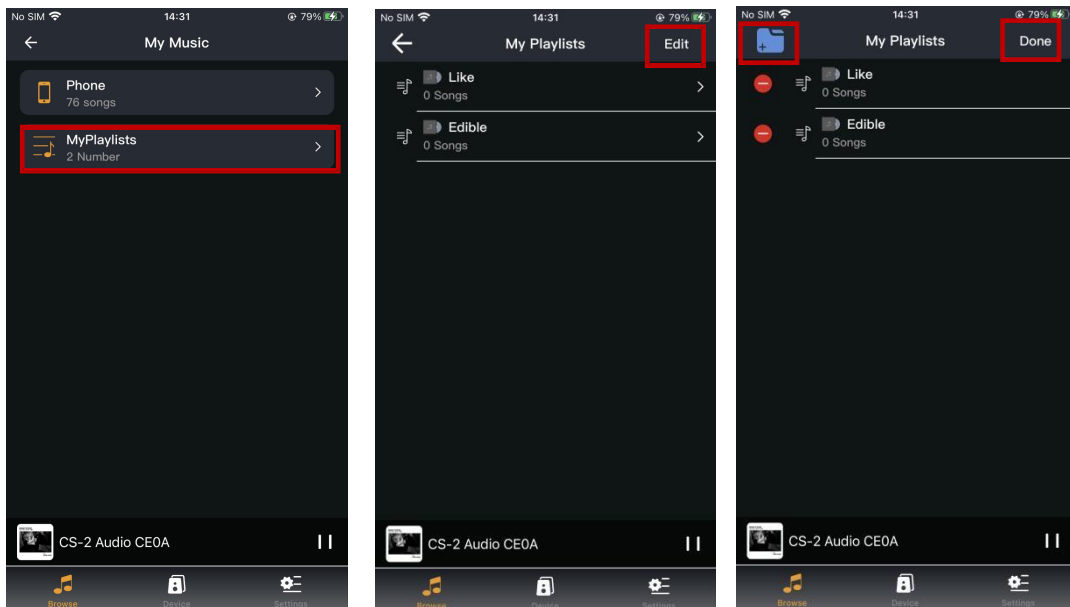

( Figure 11)

## 2.5 Music Services

The app provides quick access to selected music sources, including Tidal, Tuneln, Qobuz, Music, Spotify, Yandex, YouTube, vTuner, and QQ Music. Users can adjust the visibility of these interfaces in the Settings menu (see Figure 12).



( Figure 12)

### 2.5.1 Tidal Usage

In the Browse interface, open Tidal under Music services to access its login page. Once logged in, you can directly select songs to push to your device for playback (see Figure 13).

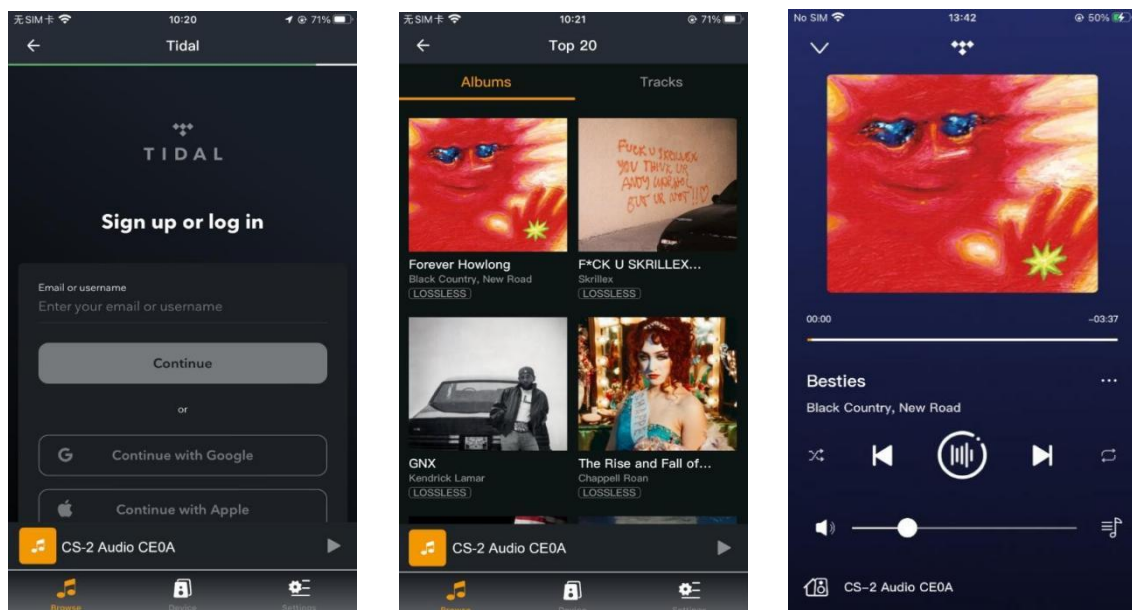

( Figure 13)

## 2.5.2 Qobuz Usage

Open Qobuz in the Music services section of the Browse interface. You'll see the Qobuz login screen. Once logged in, you can directly select songs to push to your device for playback (see Figure 14).

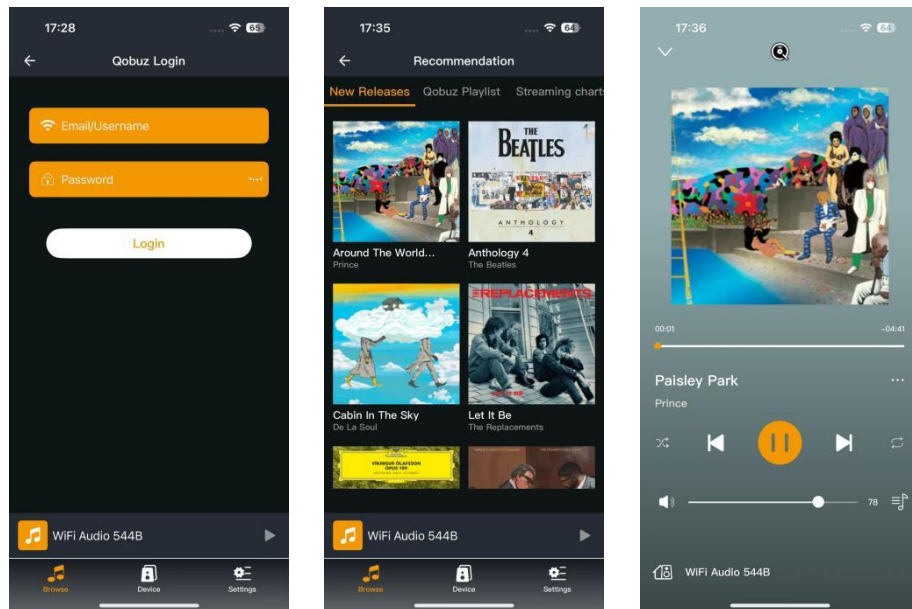

( Figure 14)

## 2.5.3 TuneIn Usage

In the Browse interface, open TuneIn under Music services to view various broadcast lists. Within TuneIn's broadcast list, you can directly select broadcasts to push to your device for playback (see Figure 15).

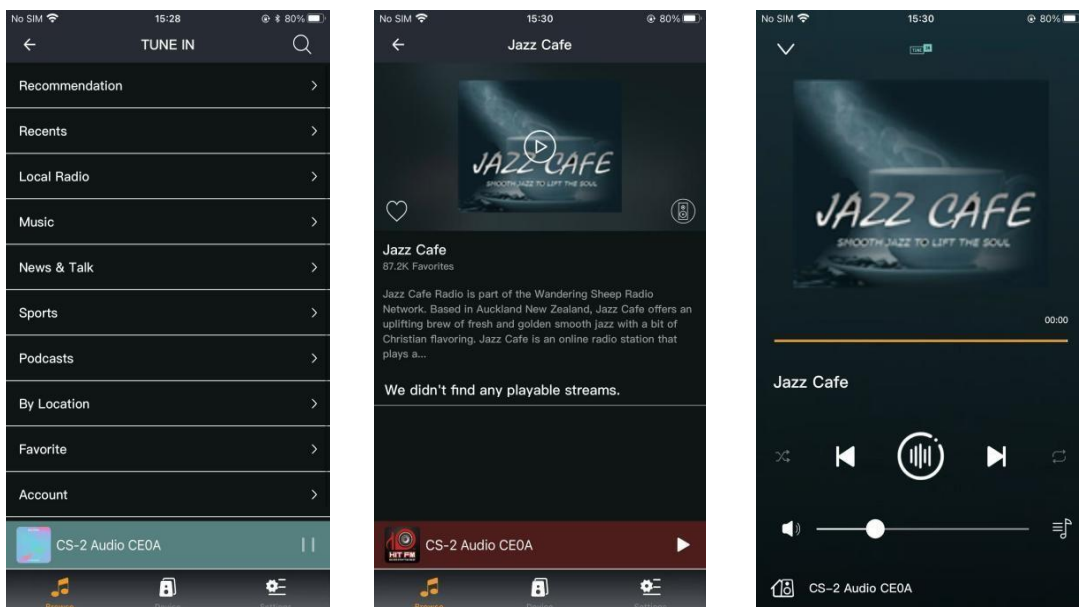

( Figure 15)

## 2.5.4 VTuner Usage

In the Browse interface, open VTuner under Music services to view a list of various radio stations. Within the VTuner radio list, you can directly select stations and push them to your device for playback (see Figure 16).

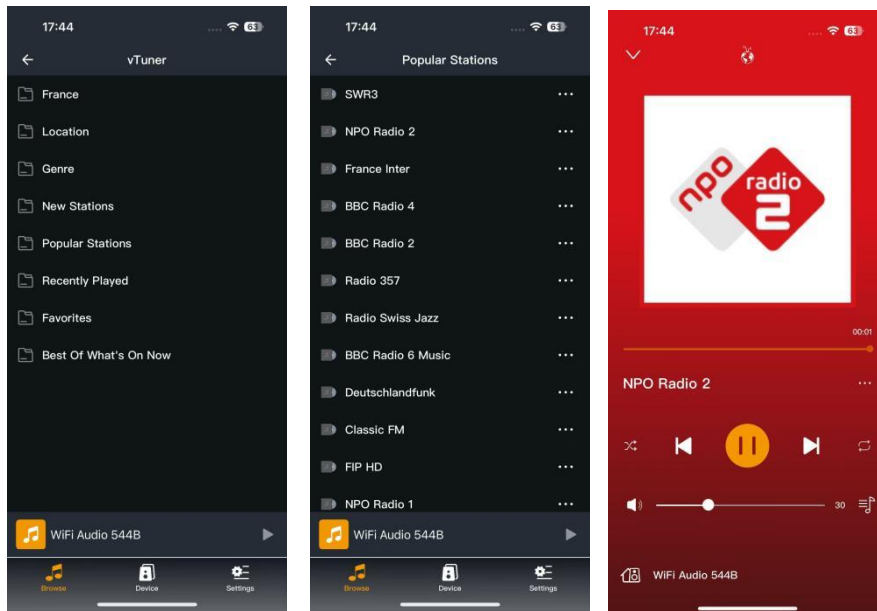

( Figure 16)

## 2.5.5 USB Disk Usage

When the device insert a USB Disk, it will appears in the Music services section of the Browse interface. Opening the USB Disk reveals its playlist, you can directly select and push songs to the device for playback (see Figure 17).

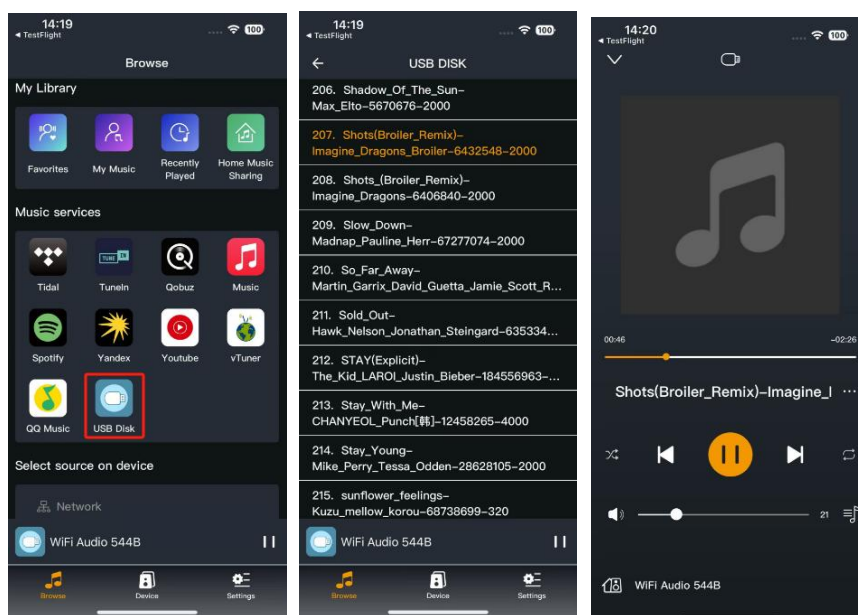

( Figure 17)

### 3. Third-party player song push

#### 3.1 DLNA

When playing music with a third-party music player, songs can be pushed to wireless devices within the local area network via the DLNA protocol (or Qplay) (see Figure 18).

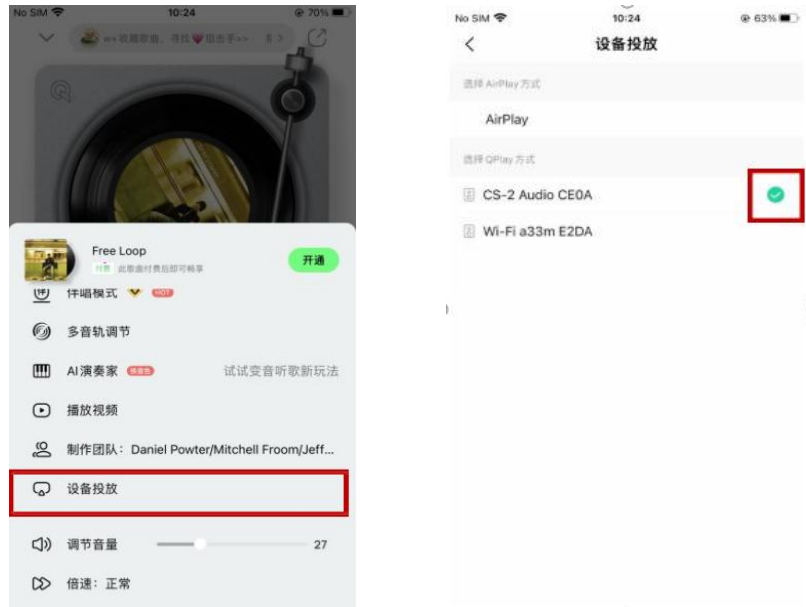

( Figure 18)

#### 3.2 Spotify Connect

When playing music with the Spotify player, you can push songs to wireless devices on the local area network via Spotify Connect (see Figure 19).

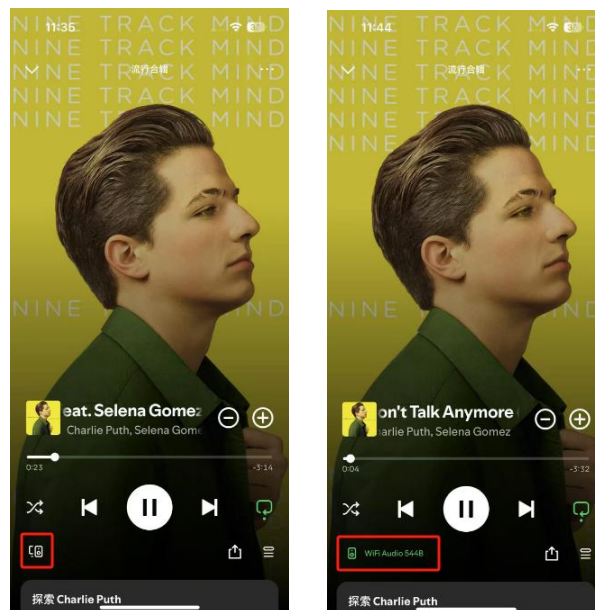

( Figure 19)

### 3.3 Qobuz Connect

When playing music with the Qobuz player, you can push songs to wireless devices on the local area network via Qobuz Connect (see Figure 20).

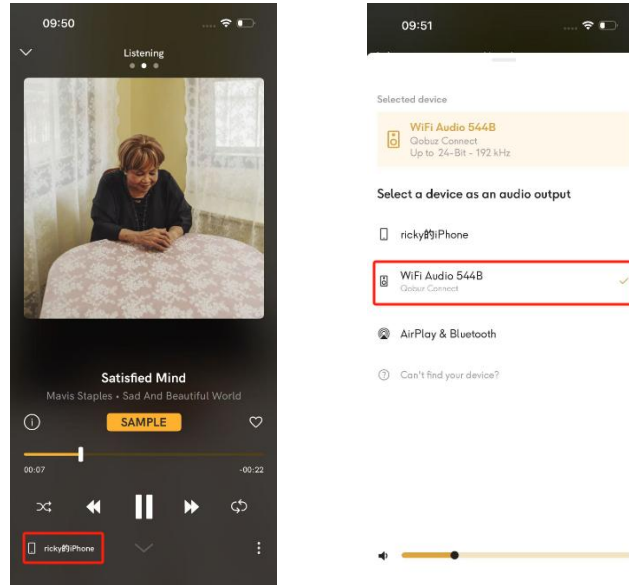

( Figure 20 )

### 3.4 Airplay

To demonstrate the AirPlay function using Apple Music as an example, open Apple Music, select the song you want to play, and then select the device you want to play the music from the AirPlay list (see Figure 21).

Note: If you're having trouble pushing Airplay, try restarting your Apple device or audio device and make sure your network connection is consistent.

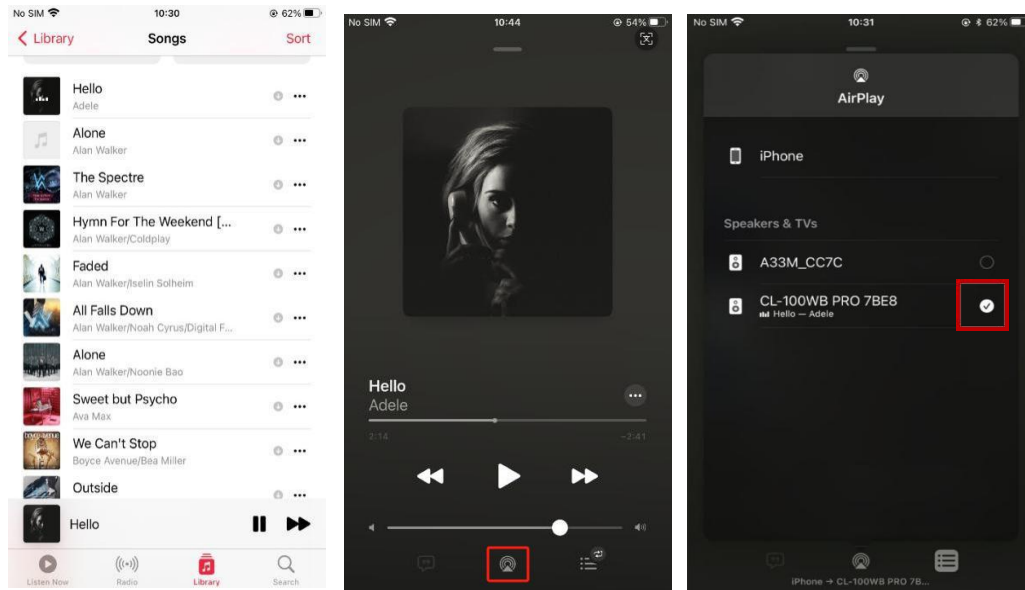

( Figure 21 )

## 4. EQ

In the Device interface, click the device settings icon  for the device whose EQ you want to configure, then click EQ to enter the EQ settings interface. Note: If the EQ option is not present in the Device interface after the device update, you need to restore the device to factory settings.

### 4.1 Bass and Treble instructions

In the Bass Treble interface, adjust the bass and treble levels by dragging the slider (see Figure 22).

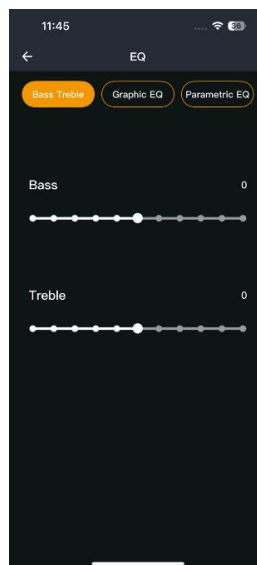

( Figure 22)

### 4.2 Preset EQ Settings

Configure the preset EQ in the Graphic EQ interface (see Figure 23).



( Figure 23)

Please use any of the following methods to set the preset EQ:

Method 1: Select a preset EQ based on your auditory scenario, and then click "Apply" to apply it (see Figure 24).

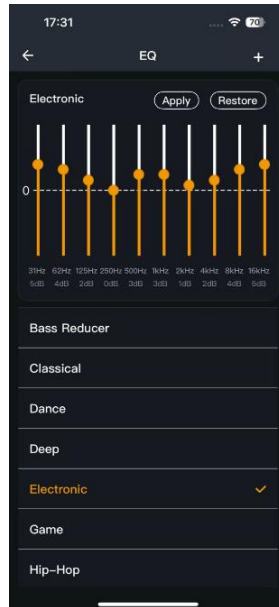

( Figure 24 )

Method 2: Use the sliders to adjust the gain levels of the 10 fixed frequency bands. If needed, click "Apply" to save your EQ settings and customize the name for future use or other functions (see Figure 25).

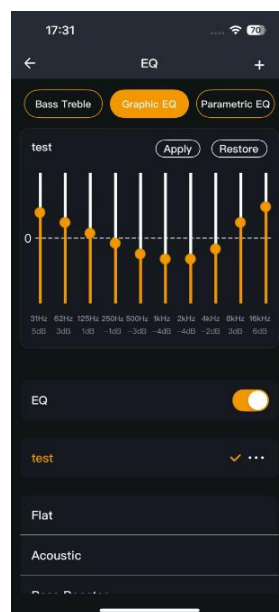

( Figure 25 )

### 4.3 Parameter EQ instructions

Scroll down in the Parametric EQ interface to view all 10 equalization bands, each with four adjustable parameters (see Figure 26).

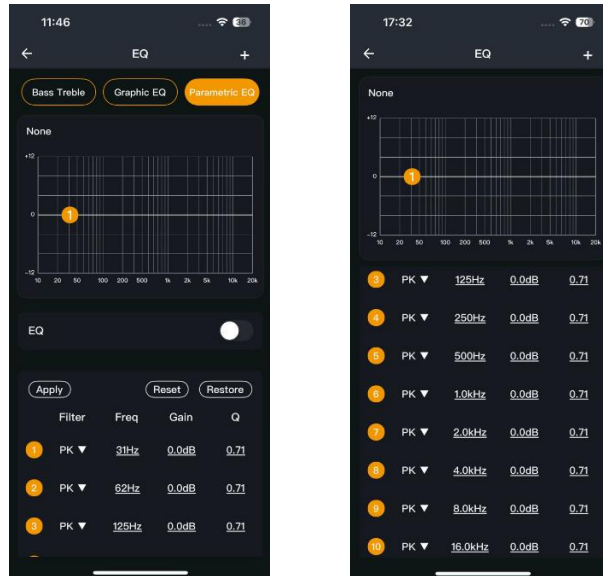

( Figure 26)

Select any equalization frequency band point, you can set it by using parameters or dragging the equalization frequency band point, then click the "+" in the upper right corner to name and save it, then select the saved named parameter EQ and click "Apply" to apply it (see Figure 27).

Note: The parameter EQ and preset EQ functions cannot be enabled simultaneously; only one can be used at a time. When setting the EQ, please ensure that the other mode is turned off first to avoid conflicts.

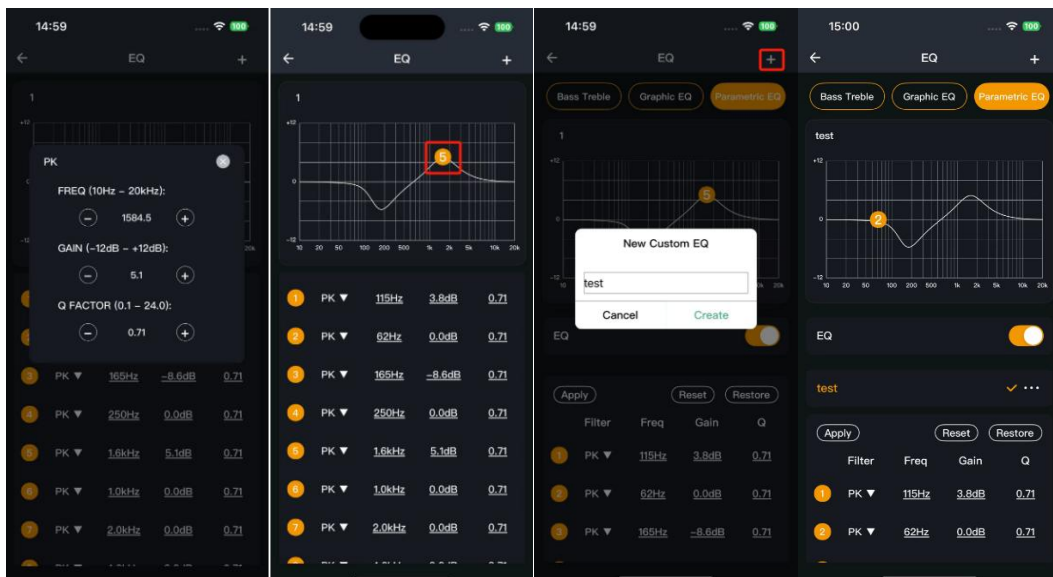

( Figure 27)

## 5. Home Music Sharing

### 5.1 Play music from shared files

To play music from your computer's shared folder via iAudioCloud, ensure your phone and computer are connected to the same local network, then follow these steps:

- ① To set up network sharing: On your computer, right-click the folder you want to share, select "Properties" > the "Sharing" tab, and set it as a network shared folder. Also, ensure that network discovery and file sharing are enabled on your computer.
- ② Get the shared path: Record the network path of the shared folder (e.g., \\computer name\music)..
- ③ Add a shared path: In the "Browse" interface of the iAudioCloud app, go to "My library" > "Home music sharing". Click the "Add" button in the upper right corner and enter the network path of the shared folder you have set up on your computer.
- ④ Browsing Content: After adding successfully, open the shared folder, and you can browse the songs, playlists, and playlists in it.
- ⑤ Push playback: In the song list, simply select the target song to push it to the device for playback (see Figure 28).

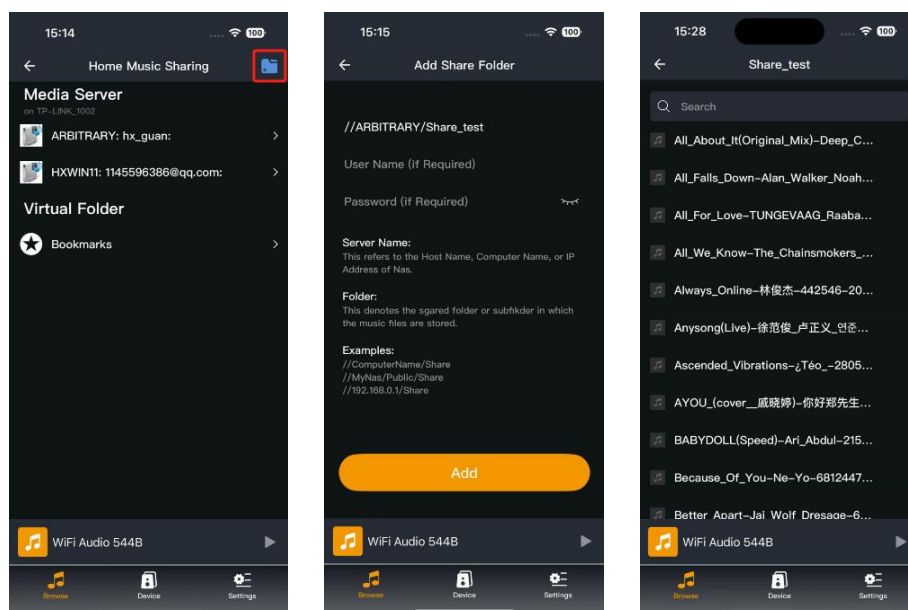

( Figure 28)

## 5.2 Play music from media server

To play music from your computer's media server via iAudioCloud, ensure your phone and computer are connected to the same local network, then follow these steps:

- ① Go to your computer's "Control Panel" > "Network and Internet" > "Network and Sharing Center" > "Advanced sharing settings".
- ② Make sure the "Network Discovery" and "Media Streaming" options are enabled.
- ③ In the "Media Streaming Options," set your music library folder to shared and grant your audio devices access.
- ④ Open the iAudioCloud app, click "Browse" > "My library" > "Home music sharing".
- ⑤ Find and open your media server in the list.
- ⑥ Browse songs, playlists, or other playlists on the server, and simply click on a song to push it to your device for playback (see Figure 29).



( Figure 29)

## 6. Subwoofer

### 6.1 Device Pair and Automatic Reconnection

After the subwoofer successfully completes network configuration, it needs to be paired to the master speaker. Once the pairing is successful, the subwoofer will enter the smart reconnection mode: in the network working mode, if it is not currently connected to the master, the subwoofer will continuously search for its paired master device and immediately establish a connection upon discovery, quickly reconfiguring the multi-room audio system (see Figure 30). To unpair the subwoofer, you can use any of the following methods:

- Manually disband the group: In the multi-room management interface of the iAudioCloud app, manually disband the corresponding speaker group.
- Reconfigure the network: Perform the reconfiguration process on the subwoofer, and its binding information will be cleared.
- Restore to factory settings: Restore the subwoofer to the factory default state through the device or app, and this operation will clear all personalized settings.

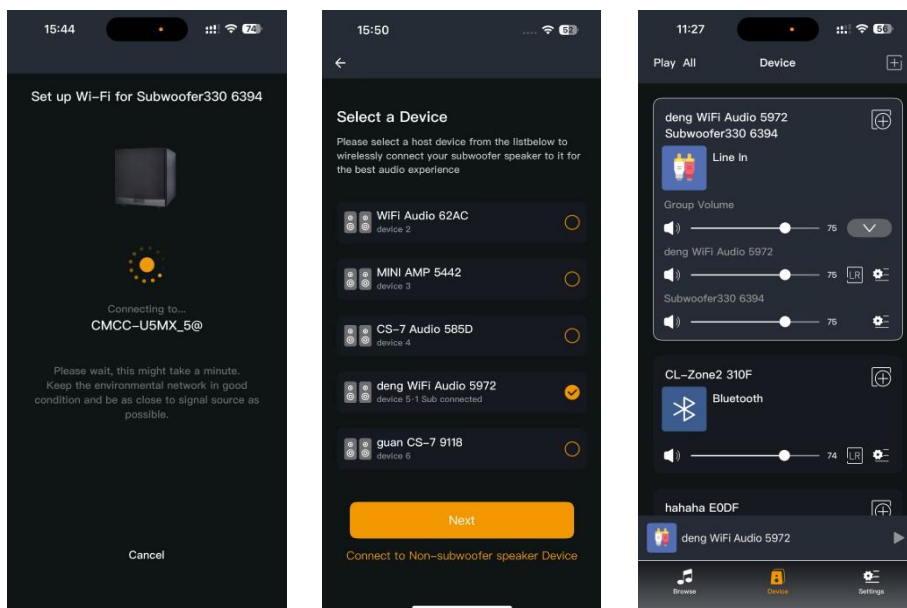

( Figure 30)

## 6.2 Functional Features and Usage Restrictions

To ensure the best experience, please note the following features and limitations of the subwoofer:

- **Role restriction:** Subwoofer can only be added as an extension device to a multi-room system and can't be used as the master device for a multi-room group.
- **Playback restriction:** The subwoofer can't decode or play streaming music independently. It must rely on the connected master speaker to receive and transmit audio signals.
- **Channel settings restriction:** The subwoofer does not support separated left and right channel settings.
- **Exclusive Sound Effect Adjustment:** The device provides an independent EQ adjustment function specifically for the subwoofer, allowing users to customize settings based on their listening preferences.
- **Volume initialization:** After rebooting, initial volume of the device will be determined by the physical position of the hardware knob (see Figure 31).

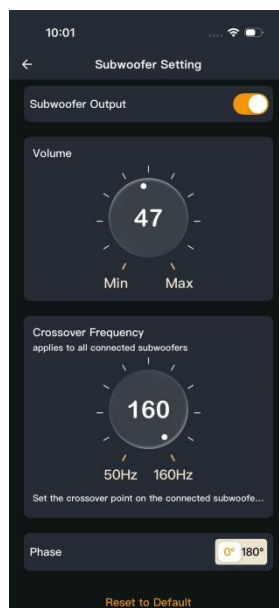

( Figure 31 )

## 7. Left and Right Audio Channels

**LR** represents stereo, **L** indicates setting both channels of the device as left channels, and **R** indicates setting both channels of the device as right channels (see Figure 32).

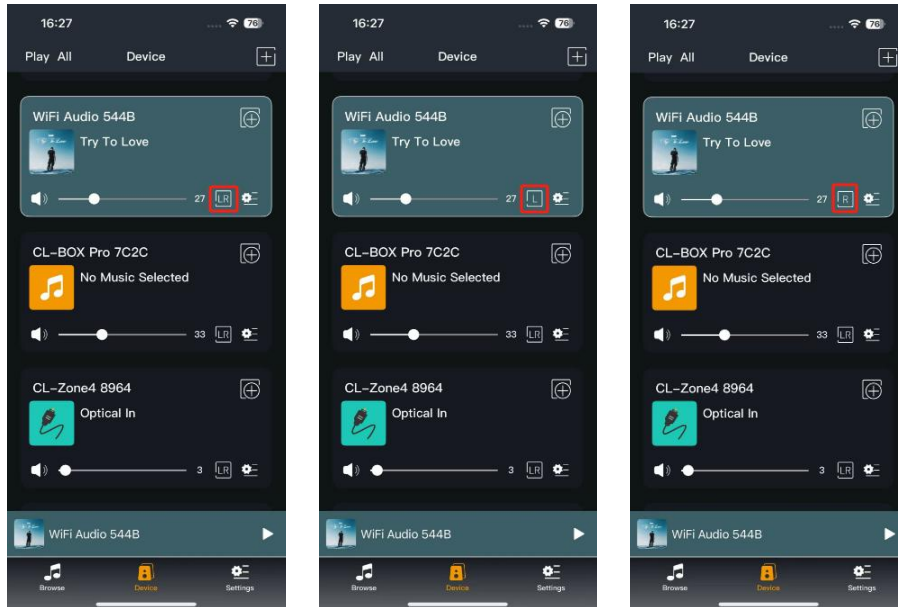

( Figure 32)

## 8. Network Status

In the Device interface, click the settings icon  of the device for which you want to view the network status, then select Network Status to access the Network Status interface (see Figure 33).

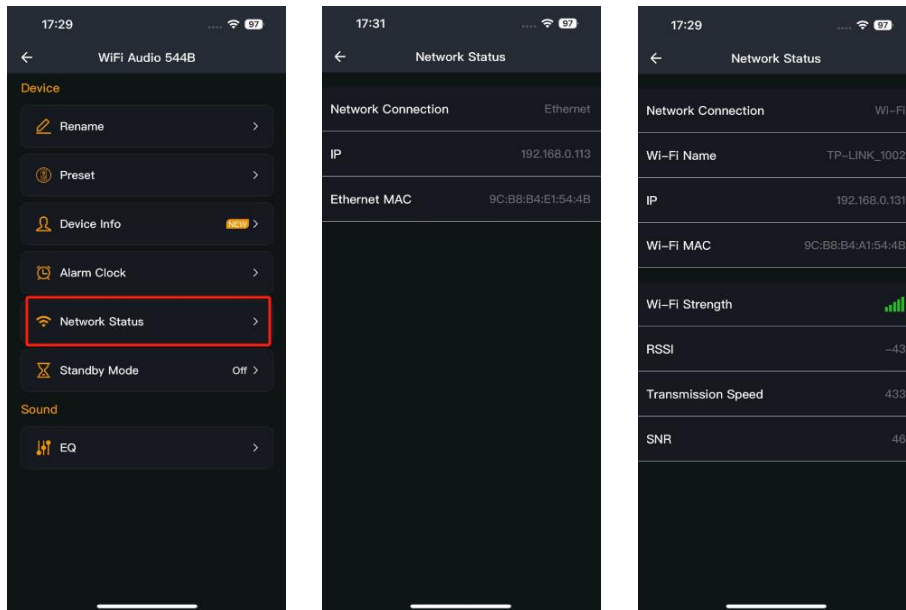

( Figure 33)

## 9. Advanced Features

The device also supports remote control via HTTP and HTTPS commands, which can be used for automated integration. The command set includes functions such as playback, volume adjustment, and EQ adjustment. For more instructions on operation commands, please refer to the [HTTPS API for A33M User Manual](#).

### 9.1 Timed Control

#### 9.1.1 Set-time Playback

In the Device interface, click the setting icon  for the device that needs to be set for timed playback, then click "Alarm Clock". In the Alarm Clock interface, click "+", and then click "Music" to set the songs for scheduled playback (see Figure 34). Currently, the timed playback songs are only supported from Tidal, Qobuz, TuneIn and vTuner.

Note: Timed playback requires the device to be powered on and connected to the Internet to trigger.

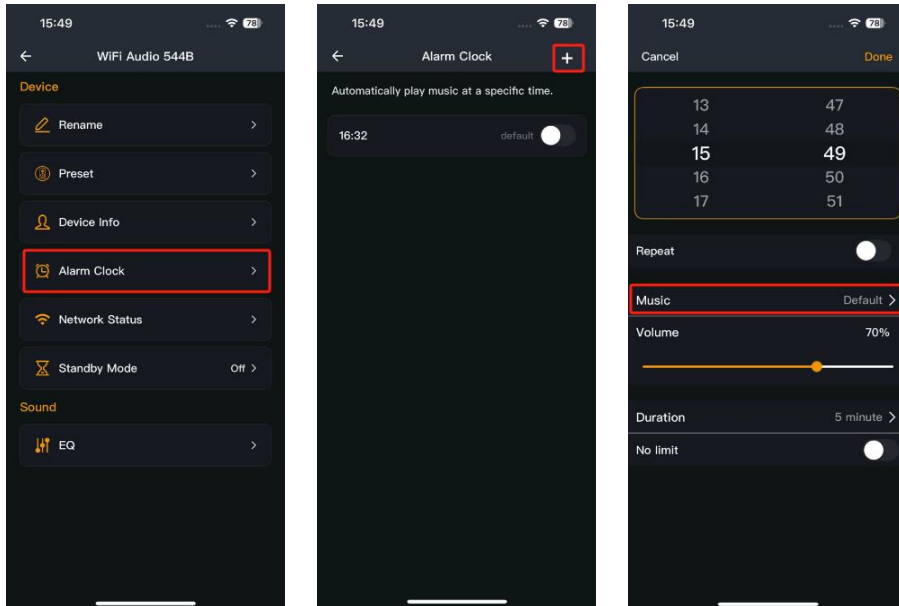

( Figure 34 )

### 9.1.2 Set-time Sleep

In the song playback details interface, click the icon , then click Sleep Clock, and the Sleep Clock interface will appear, where you can set the sleep timer duration (see Figure 35).

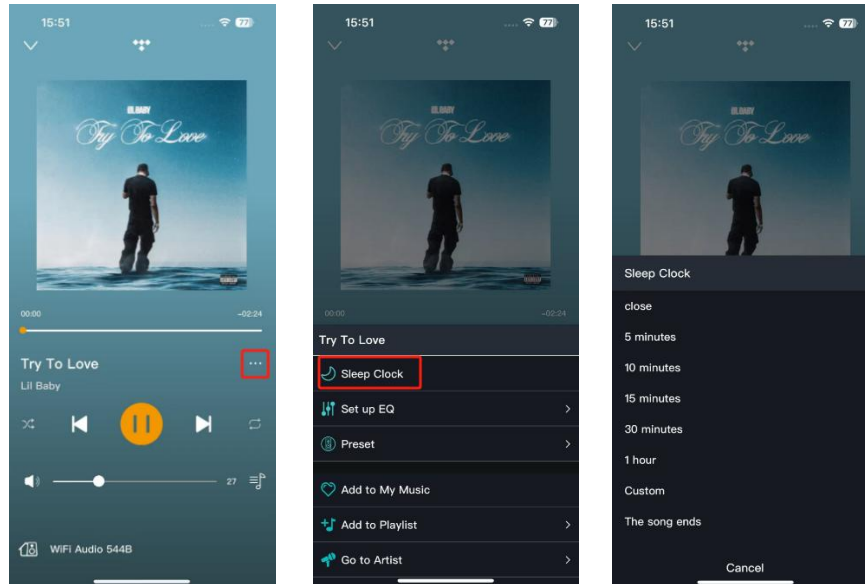

( Figure 35)

### 9.1.3 Timed Standby Mode

In the Device interface, click the device setting icon  for the device that needs to be set for timed standby, then click "Standby Mode". The Standby Mode interface will appear, where you can set the timed standby duration (see Figure 36).

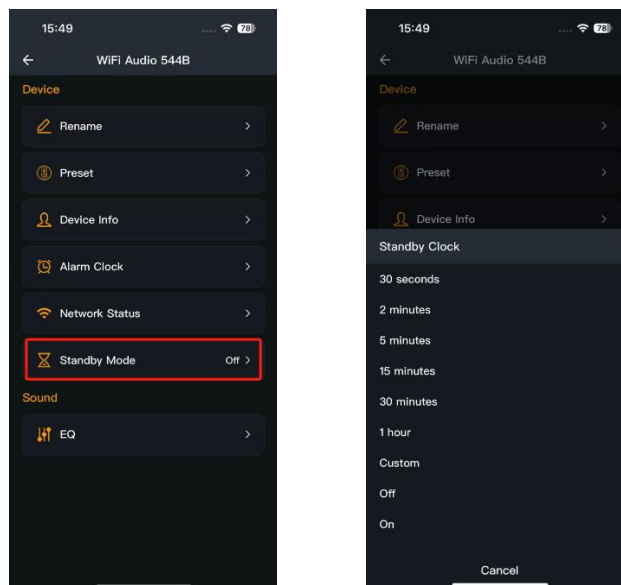

( Figure 36)

## 9.2 Preset Playback

The preset playback function allows you to quickly save and recall your favorite songs and their playback settings with one click, greatly improving the convenience of use. You can save specific songs, source inputs, and sound modes for each preset.

### 9.2.1 Creating and Overwriting Presets

To quickly save the currently playing song as a preset, follow these steps:

- ① Click the icon  on the song playback details screen.
- ② In the pop-up menu, select the Preset option to enter the Preset interface.
- ③ In the Preset interface, click on a preset location labeled Empty to add the current song to this location (see Figure 37).

To replace an existing preset, simply click on a non-empty preset position to override.

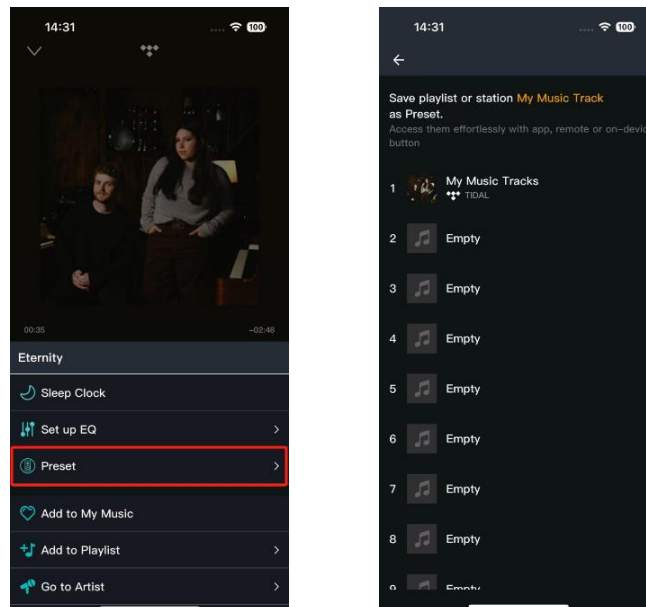

( Figure 37)

### 9.2.2 Managing the preset list

- ① On the Device interface, tap the target device's settings icon  and select Preset to enter the Preset interface.
- ② Click the "Edit" button in the upper right corner to enter the list management

mode.

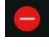
③ Delete a preset: Click the delete icon  next to the preset item to remove the preset song from the list.

④ Sort presets: Long press the sort icon  of a preset item and drag it to adjust its display order in the list (see Figure 38).

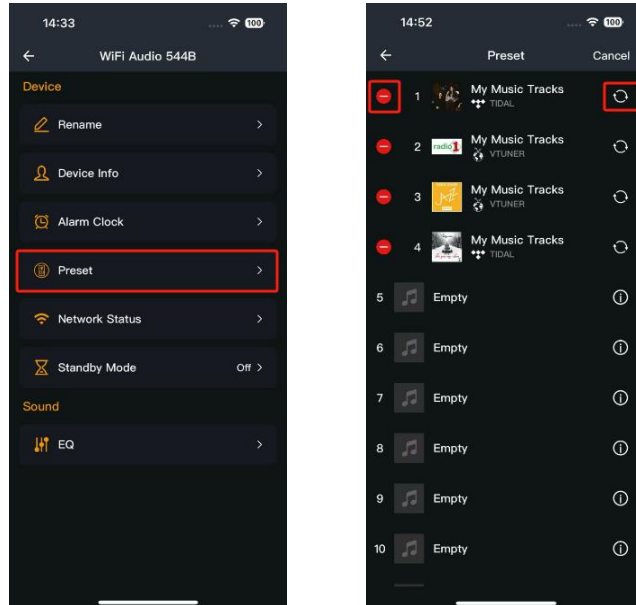

( Figure 38)

### 9.2.3 Edit Preset Parameters

- In the Preset interface, directly click the edit icon  in any preset position to enter the Edit Preset interface (see Figure 39).

- Edit presets for existing songs:

If a preset song has been saved in this location, you can set the loop mode (such as single song loop, list loop), shuffle mode for it, and click EQ to set the saved preset EQ or parameter EQ configuration.

- Set the input source for empty preset bits:

If the position is empty or the preset input source, you can click Audio Input to set the sound source of the device when this preset is triggered, the specific input mode depends entirely on the hardware configuration of the device itself, including but not limited to Network, AUX In, Bluetooth and USB Disk modes, etc., as well as EQ settings.

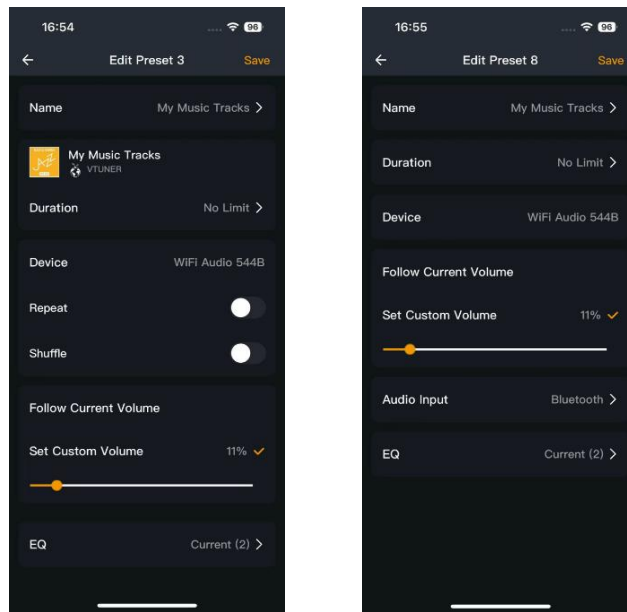

( Figure 39)

## 9.3 Firmware Update

### 9.3.1 Manual Update

When there is a new firmware available for update, an orange arrow will be displayed on the Device interface or the "NEW" label will appear on the Device Info interface, indicating that an update is possible. A green arrow indicates that the device is in the process of updating. Clicking either the orange arrow or the "NEW" label will open an upgrade pop-up window. Then, click "Upgrade" to complete the update (see Figure 40). The interface during device update (see Figure 41).

In addition to the above-mentioned update method within the APP, three other update methods are also supported: Web, PC tools, and USB drive. For detailed instructions, please refer to [Web Update](#), [Tool Update](#), and [Udisk Update](#).

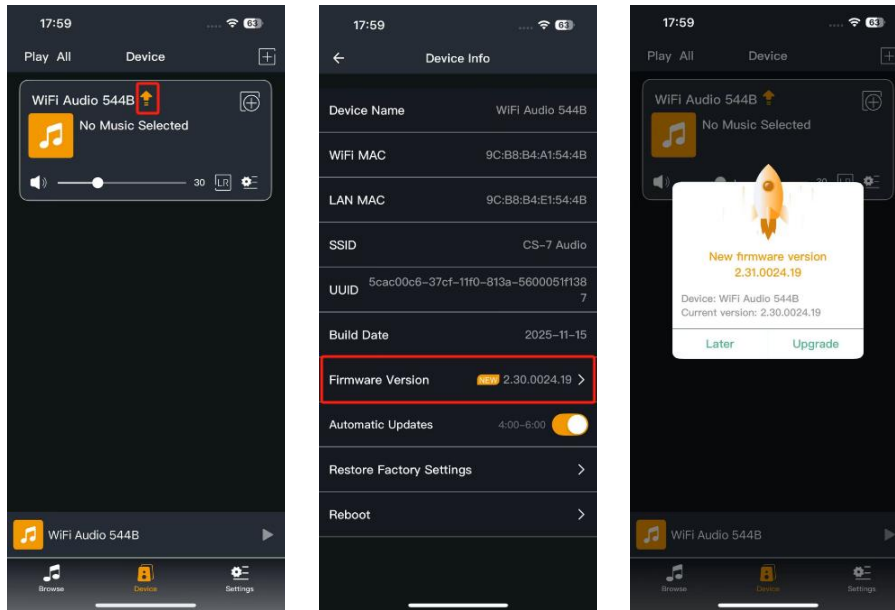

( Figure 40)

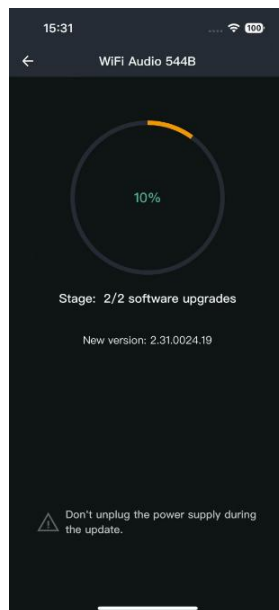

( Figure 41)

### 9.3.2 Silent Update

Silent updates are performed between 4:00 AM and 6:00 AM local time, during the update process, all sounds will be muted. Users can click "Automatic Updates" in the Device Info interface to set the time period for silent update. It should be noted that silent update must be enabled first before clicking on "Automatic Updates" to set the time period for silent update (see Figure 42).

Note: After agreeing to enable silent updates, the device must be powered on and connected to the internet during the time period you set. If the device is turned off or disconnected during this period, it will miss this update and will need to be upgraded manually. As long as the device fails to complete the update successfully, the system will automatically retry detecting silent updates within the set time period every day until the upgrade is successful.

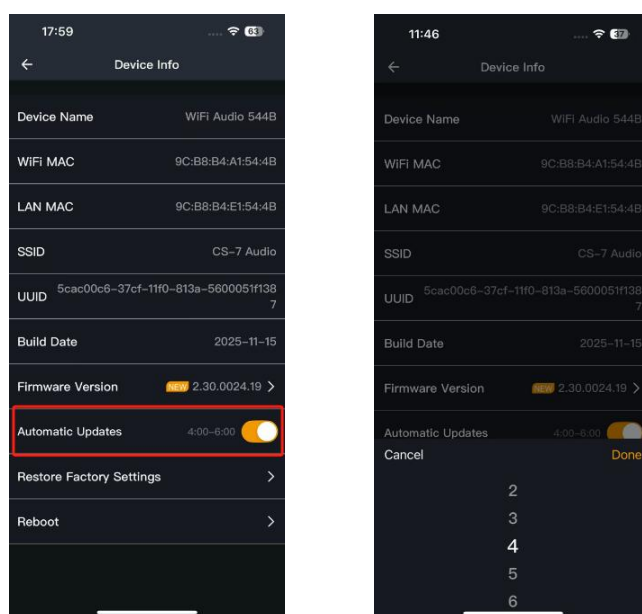

( Figure 42)

## 9.4 Question feedback function

If you encounter any issues or suggest improvements while using your device, you can contact us directly through the app's built-in feedback feature. Here are the detailed steps and suggestions.

### 9.4.1 Feedback operation steps

- ① In the Device interface of the App, first select the specific device corresponding to the issue you wish to report.
- ② Click the Settings icon in the lower right corner.
- ③ Find and click on the "Send us feedback" option in the Settings interface.
- ④ In the "Send us feedback" interface, please clearly and detailedly describe the

problem or suggestion you encountered (see Figure 43). After filling out the form, click "Send" to submit the information to our technical support team.

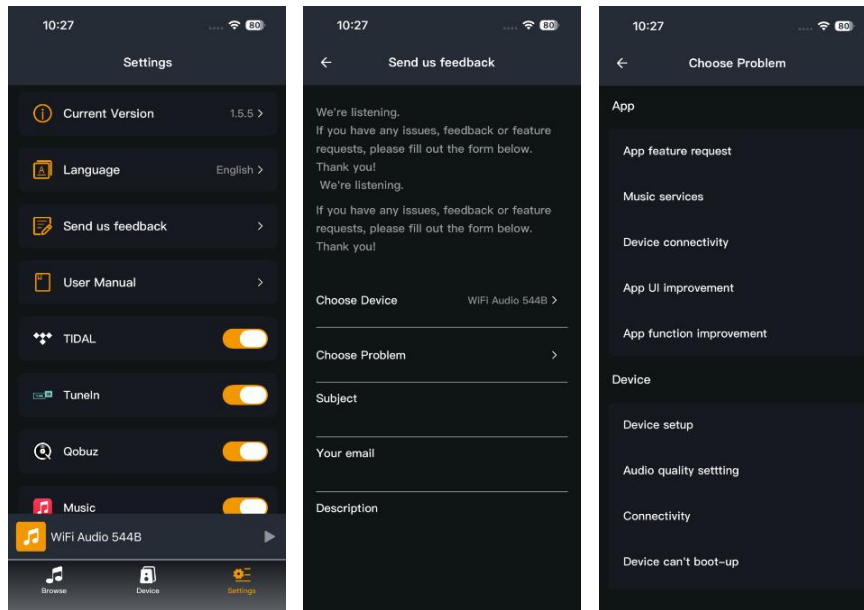

( Figure 43)

#### 9.4.2 Feedback information suggestions

To help us quickly locate and resolve the issue you're experiencing, please include the following information in your description:

- Problem Phenomenon: Describe in detail what the problem is, such as "device won't connect to WiFi" or "stuttering when playing a song".
- Reproduction steps: Describe the operation under which the problem occurred, and provide as many specific steps as possible to reproduce the issue.
- Device and environment information: Provide the device model, firmware version number, and the version of the mobile operating system (such as iOS 17.5 or Android 14). This will greatly enhance the efficiency of problem troubleshooting.

## 10. FAQs and Support

- Due to the diversity of Android devices, if an APP fails to function properly, what should I do?
  - Uninstall the iAudioCloud application completely.
  - Access the official app store, re-download and install the latest version.

- If the issue persists, restart your phone and perform the operation again.
- If the above operations still fail to solve the problem, pls contact technical support for further assistance.

- iPhone iOS 26 configuration network exception description.

Currently, after Apple devices are upgraded to iOS 26, the app cannot automatically recognize the WiFi network name during the network provisioning process, and will not keep a record of the last successful password entered (see Figure 44).Therefore, please manually enter the correct WiFi name and password during network configuration.

- This issue is a system-level compatibility anomaly and needs to be fixed by subsequent iOS system updates.

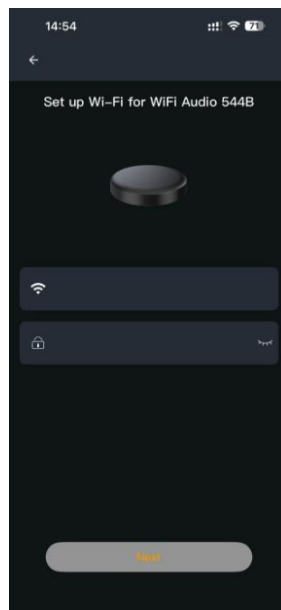

(Figure 44)